

Product Information **VINTERKÖLD**

en

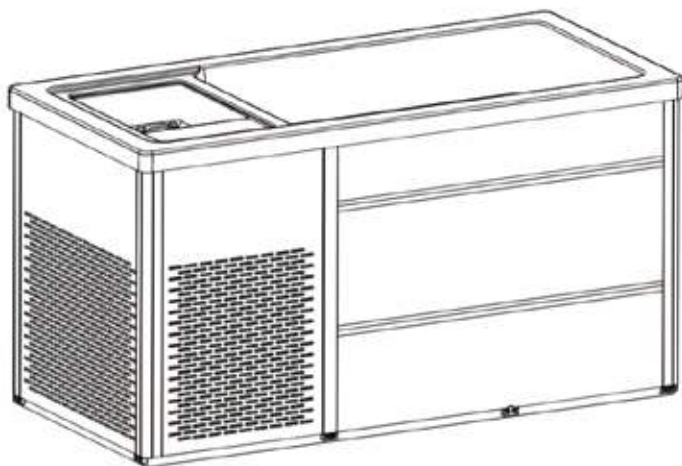

Vastera

70" x 33" x 37.5"
1780 x 840 x 950 mm

vers. 202308.1

Please record your
Spa Bath Serial Number here.

* Spa Bath serial number is located on the galvanized steel frame.

Embrace the Revitalizing Chill

Experience the invigorating benefits of cold therapy through our innovative Vinterköld product. Cold therapy, also known as cryotherapy, involves subjecting the body to cold temperatures for therapeutic purposes. With its age-old roots and modern applications, this practice offers diverse and remarkable benefits for your well-being:

- **Reduced Inflammation:** Cold therapy is a natural anti-inflammatory. It helps to constrict blood vessels, reducing blood flow to inflamed areas and thereby alleviating swelling and pain. Whether you're recovering from an intense workout or seeking relief from sore muscles, our Vinterköld can provide the cool comfort your body craves.
- **Faster Recovery:** Athletes and fitness enthusiasts often turn to cold therapy to accelerate recovery times. The controlled exposure to cold temperatures promotes quicker muscle repair, reduces muscle soreness, and aids in preventing overexertion.
- **Increased Circulation:** Paradoxically, cold therapy can lead to improved circulation. As the body responds to cold, it works to keep vital organs warm by increasing blood flow to the core. Once you exit the cold environment, this increased blood flow returns to the extremities, promoting better overall circulation.

- **Enhanced Mental Well-being:** Cold therapy is not just about physical benefits; it can positively impact your mental state too. The shock of cold triggers the release of endorphins, which are natural mood lifters. Many people find that cold therapy leaves them feeling refreshed, invigorated, and more mentally focused.
- **Boosted Immune System:** Regular exposure to cold temperatures has been associated with improvements in the immune system. It stimulates the production of immune cells and activates the body's natural defense mechanisms, helping you stay resilient against illness.

With a Vinterköld, you can integrate the power of cold therapy seamlessly into your routine. Whether you're looking to enhance your recovery, reduce inflammation, or simply invigorate your senses, the Vinterköld offers a convenient and effective solution.

Embrace the chill and unlock a new realm of well-being today.



Premium Materials

Embrace the chill and rejuvenate your body and mind with our product, showcasing an Acrylic Surface for aesthetics, an AluCombo Cabinet for efficient cooling, an aluminum frame for

durability, and an insulated pipe sleeve to prevent condensation. Perfect for year-round outdoor use, energy-efficient, and reliable. Enjoy hassle-free cooling without water-related concerns.

1

Acrylic Surface



3

Tri-layered Side Cabinet



2

Aluminum Frame

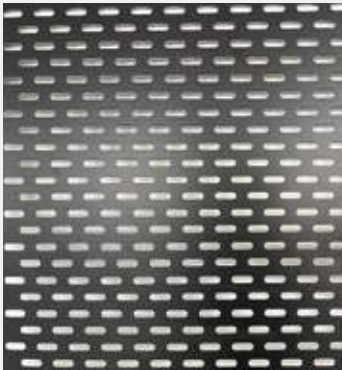

4

Insulation Sleeve





Contents

- Installation & User Manual 1
- How To Set Up 2
- Important Safety Instructions 3
- Specification 4
- Understanding the Control Panel Setting 5
- Control Panel Function 6
- Preparing for Your New Vinterköld 7
 - Exhaust Air and Replace Filter 7
 - Power Supply and Drainage 8
 - Normai Drainage 9
 - Condensate Drainage10
 - Remove and install the skirt11
- Usage12
- Troubleshooting12

Installation & User Manual

 **Warning!** Risk of fire, electric shock and and water leakage.

 Your Vinterkøld includes a detailed Installed Installation & User Manual. Follow all instructions in the Installation & User Manual closely.

 **Warning!** In-proper installation, usage or maintenance can lead to loss of warranty, injury or property damage. Spa Bath to be installed in accordance with BCA and local regulatory standards by qualified persons only. An isolation switch is recommended. Electrical installation must comply with AS:3000-Electrical Wiring Rules.

Suggested Tools For Installation

The following tools are required to install your bathtubs. Additional tools may be required depending on the installation circumstances.

- 1. Water level
- 2. Sealant
- 3. Adjustable spanner or spanner in required sizes
- 4. Screw driver
- 5. PTFE sealing tape or suitable substitute

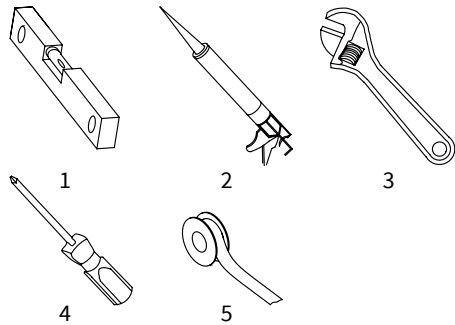

Package List



Aqua-Shield Lid



HydroPur Filter



Option:
Easy-Access Stair



Option:
HeatArmor Cover

How To Set Up

If you're eager to experience the benefits of your fresh Vinterköld, take the first step by following these straightforward guidelines to begin your journey.

While we understand your excitement, we strongly advise going through the complete instruction manual, especially the safety details, before embarking on your cold therapy sessions with the Vinterköld. Your safety and optimal enjoyment are our priorities.

1

Place the cold tub in a suitable location and fill it with water through the filter until the water level reaches the recommended mark as specified by the manufacturer.

2

Open the air bleed screw to exhaust air from the filter and pump housing. See the manual for more information on how to fit in detail.

3

Plug the cold tub into a 120V/ 60Hz power source and set the desired temperature using the control panel.

4

Within a few hours, you can enjoy the refreshing experience of cold water therapy.

5

We strongly suggest regularly cleaning and sanitizing and repeat these steps.

Important Safety Instructions

READ AND FOLLOW ALL INSTRUCTIONS

Taking the plunge is a significant step, and Bellagio Spas disclaims all liability for damages due to failure to follow the provided guidelines.

• Health Disclaimer

If unsure, consult your doctor before using the Vinterköld. While generally suitable for most individuals, those with reduced mobility or sensory/cognitive abilities should use the Vinterköld under supervision and only if knowledgeable about safe usage and potential risks.

• Temperature Awareness

Start with a higher temperature (59°F / 15°C) and a shorter duration (1-2 minutes) instead of going straight for 15 minutes at 46°F (8°C).

• Gradual Adaptation

Tolerance to cold water varies. Gradually increase Vinterköld usage time. Sudden immersion can shock the body; enter slowly, keeping face, shoulders, and hands above water until breathing is steady.

• Cold Exposure Risks

Cold shock response decreases with exposure experience. Hypothermia is a risk - it leads to loss of consciousness and heart failure. Duration in cold water depends on factors like temperature, body size, and experience. Consult your doctor. Start with brief dips to find limits. Exit if uncomfortable.

• Safety Precautions

- Supervise children around the Vinterköld.
- Pregnant women, children, and those with medical conditions must consult a doctor before using.
- Avoid alcohol or drugs before use.
- Do not use in extreme weather or flood conditions.
- Ensure proper drainage to avoid water accumulation.

• Maintenance

- Be cautious when entering and exiting the Vinterköld.
- Keep the inlet clean to protect the pump.
- Avoid using electrical appliances nearby when empty.
- Use only approved cleaning agents; rinse thoroughly.
- Do not pressure wash the Vinterköld.
- Keep the cover on to prevent injuries and water ingress.
- For repairs, consult Vinterköld's approved engineers.

• Power Supply Safety

Ensure the power supply is on an RCD protected circuit for safety.

WARNING:

- The use of alcohol, drugs, or medication can greatly increase the risk of fatal hyperthermia. People with infectious diseases should not use a spa or hot tub.
- To avoid injury, exercise care when entering or exiting the spa or hot tub.
- Do not use drugs or alcohol before or during the use of a spa or hot tub to avoid unconsciousness and possible drowning.
- Do not use a spa or hot tub immediately following strenuous exercise.
- Prolonged immersion in a spa or hot tub may be injurious to your health.

CAUTION:

- Maintain water chemistry in accordance with manufacturer's instructions.

* Please read the instructions carefully and use according to the instructions. Children should use this product under the close supervision of adults.

Specification

Power Supply

Rated: 120V, 60 Hz, 7.5A
Water Flow: 20gal/Min
68L/Min

Materials

Acrylic
Aluminum
High-density PU

Dry Weight

294 lbs
133 kg

Water Capacity

79 gallons
300 liters

Temperature Control

46-104°F (8-40°C)



Draining

2-way draining:
normal drain Groove and
heat pump condensate
drain outlets

Antifreeze function

With the auto freeze-proof
function, heating will initiate
when the water temperature
drops below 40°F (4°C) and
will automatically turn off
when the temperature
reaches 48°F(9°C)

Filtration

HydroPur Filter within
arm's reach for easy
configuration and
maintenance

Cover

An aesthetic Aqua-shield Lid
that optimizes space, and
gives an interior-grade look

By default the product is equipped with the following
features as indicated in the illustration above:

1. Water Pump
2. UV Sterilizer
3. Balboa® Mini Inverter Chiller
4. Insulation Sleeves



Understanding the Control Panel Setting

Panel Function Diagram

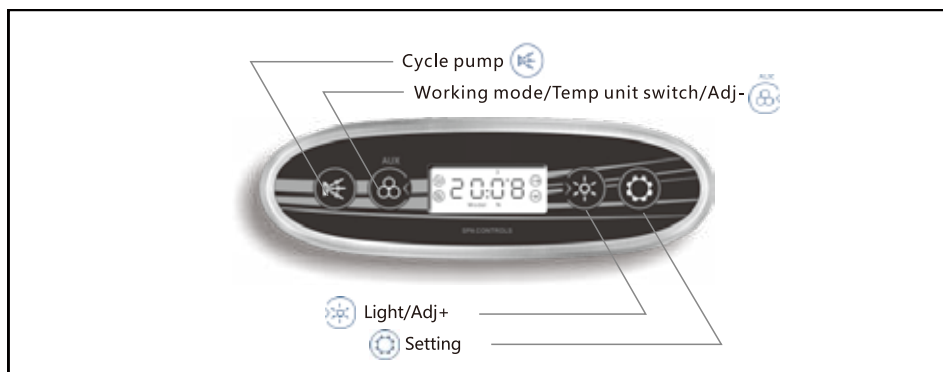

Touch Pad Usage Instructions

1. Temperature setting



When the system is powered on and not in setting mode, press " " to switch the temperature unit (°F or °C). The system will automatically save the selected unit.

To set the temperature, press the " " key until you enter the temperature setting interface. The LCD will display the temperature unit, which will flash. Then use the " " and " " keys to adjust the temperature value between the setting range 41-104°F (5-40°C). The system will store the temperature value you set.

2. Clock setting

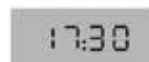

When the system is powered on, press " " button to enter the clock setting mode. The LCD will display either the hour or minute value, which will flash. Then, press the " " and " " buttons to adjust the hour and minute values.

3. Working Mode

When the system is powered on and not in the setting mode, press the " " key for 2 seconds to switch to the desired working mode. The system offers three default working modes by default (when the system is powered on, it is in the standard mode):

Standard mode (LCD displaying Model N)

- Heat & cool function will be valid in 24 hours. If system time falls in water cycle set time period, filtering water cycle function will be valid.

Economy mode (LCD displaying Model E)

- If system time falls in water cycle set time period, filtering water cycle function is valid; if system time falls in heating set time period, heat & cool function will be valid. If system time is out of the set time period, freezing proof function will be started.

Sleeping mode (LCD displaying Model D)

- Freezing proof will be started and other loads will be turned off and can not be controlled by keys.

4. Constant Temperature Function

The constant temperature function automatically activates in standard mode. In economic mode, it starts within the designated time frame. In sleep mode, the anti-freeze function runs automatically.

Once the constant temperature function is initiated, the circulation pump starts first, and the heat pump activates shortly after. If the constant temperature function is turned off, the heat pump shuts down first, followed by the circulation pump.

When the constant temperature function is enabled, the system regulates the heat pump's operation based on water temperature and the set temperature, ensuring automatic temperature control.

The temperature control setting (standard model and economy mode) are as follows:

- If the water temperature is \geq the set temperature + 34°F (1°C), the cooling function of the heat pump is activated;
- If the water temperature is \leq the set temperature - 34°F (1°C), the heating function of the heat pump is activated;
- If water temperature = set temperature, the heat pump stops.

Control Panel Function

To set the heat & cool time period (Economy mode and sleeping mode only):

When system is powered on, press "⏸" till entering timing heating time period setting interface. The correspondent time value will flash. Press "⏸" and "⏸" to adjust the time.

"1" and "2" in LCD stand for time period 1 and time period 2. "⏸" and "⏸" in LCD stand for starting and ending time of time period.

The system will automatically store the value after timing heating setting.



5. Timing water cycle

When system works in standard and economy mode, timing water cycle is valid. In sleeping mode, timing water cycle is invalid.

The control system has two water cycle setting time periods. Before usage, please set the two time periods.

If the system time is in any time periods, the water cycle will be started; otherwise, the water cycle will be turned off.

To set the water cycle time period:

When system is powered on, press "⏸" to set the timer for water circulation. The correspondent time value will flash. Press "⏸" and "⏸" to adjust the time.

"1" and "2" in LCD stand for time period 1 and time period 2. "⏸" and "⏸" in LCD stand for the starting and ending time of time period.

The system will automatically store the value after timing water cycle time period setting.



6. Freezing Proof

The freezing proof function will automatically work. When water temperature is lower than 40 °F (4 °C), heat will be started. When the temperature reaches 48 °F (9 °C), heat will be turned off.

7. Cycle Pump

When the control system is powered on and not in sleeping mode, or setting mode, press the key "⏸" to control the cycle pump.

Cycle pump will turn off automatically after running for 30 minutes.

8. UV Sterilization

UV Sterilization will automatically start when system is powered on.

9. Children lock protection setting

When the system is powered on, press constantly "⏸" until it goes to children lock setting interface. Then press "⏸" to set the children lock function. When the setting is done, the system will save it.



Children lock protection disable

Children lock protection enable

If no button is touched within 3 minutes, then all the buttons will be locked, and no operation can be done. At the same time, the LCD displays "LOC"; press and hold any button for 3 seconds to unlock the panel. All the buttons work and "LOC" disappears from the screen.

10. Light

When the control system is powered on and not in sleeping mode, or setting mode, press the key "⏸" to control light. Press the key "⏸" for 2 seconds to turn off the underwater light.

Light has two modes. In on/ off mode, light turning on and off are controlled. -In RGB mode, the control regulation is as below:

- state 1 auto color change (color changing among state 2 to state 8 in cycle)
- state 2 red
- state 3 green
- state 4 yellow
- state 5 blue
- state 6 purple
- state 7 cyan
- state 8 white
- state 9 turning off

Preparing for Your New Vinterköld

Change Your Vinterköld's Filter

Exhaust Air and Replace Filter.

- 1
- When replacing the filter element, please close the water inlet and outlet valves of the tub, loosen the filter exhaust valve by counter clockwise, then unscrew the filter cover, remove the filter element, and replace the filter element.

EXHAUST AIR



Exhaust vavle



Counter-clockwise rotation of the valve and remove it.



- 2
- Regularly cleaning your filter is the single easiest and most effective thing you can do to keep your water clear. Power and system problems can arise if the filter is clogged or dirty, causing the heater and pump to work harder than necessary, which could lead to their failure.

EXCHANGE FILTER



Turn the locking ring clockwise to loosen it.



Remove the compression ring and the filter cover.







Remove the old filter and insert the replacement filter. Proceed as in the previous step, cover the filter with the filter lid, place the locking ring, and rotate counterclockwise.

Preparing for Your New Vinterköld

Efficiently draining your Vinterköld.

Power Supply and Drainage.

POWER SUPPLY



Power Supply



Install the Threading hole cover

DRAINAGE



Normal drain outlet

Groove and heat pump condensate drain outlet
* Self-prepare an external drainage pipe

Preparing for Your New Vinterköld

Efficiently draining your Vinterköld.

Normal Drainage.

- 1** To drain water, pull out the drainage valve and rotate the cap counterclockwise.

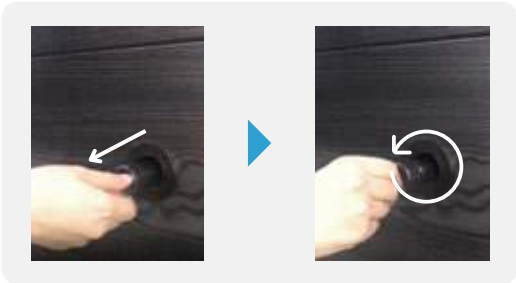

- 2** Water will begin to drain. Pushing the valve inwards increases the water flow, while pulling it out reduces the water flow.

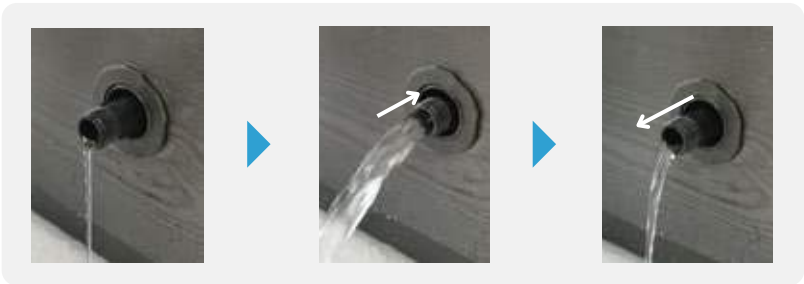

- 3** To stop the drainage, rotate the cap clockwise and push the valve inward.

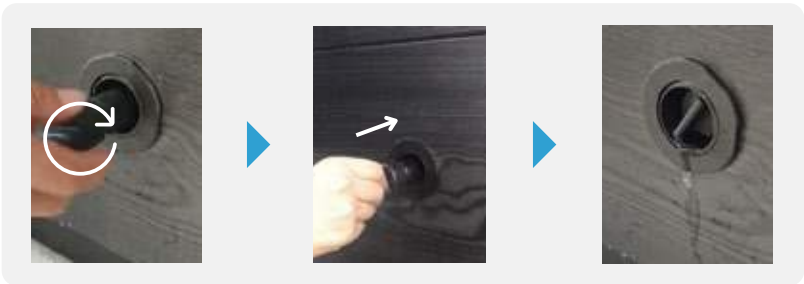

Preparing for Your New Vinterköld

Efficiently draining your Vinterköld.

Condensate Drainage

Self-prepare
the accessories



Install the connector



Connect the hose and it
is ready to use



Preparing for Your New Vinterköld

Opening the Front Door Panel for Electrical Hookup

The following electrical connections must be performed by a licensed electrical contractor. Unscrew and remove the two corner panels on each side of the spa's front door.

Remove and install the skirt.

1 REMOVE

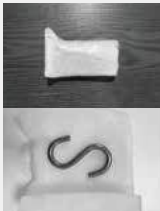

2 INSTALL



Usage

1. Turn on the power.
2. Fill the tub with water.
3. Don't press the water pump switch unless the water level in the bathtub is above the level of the jets.
4. Use the touch control pad to adjust the intensity of the jets by switching the regulator.
5. After use, press the touch control pad to turn off the pumps and drain the water.
6. Finally, turn off the power.

Troubleshooting

Symptom	Possible Solutions
---------	--------------------

Start-up problem

Pump won't prime	<p>Sometimes air may get trapped in the pump during spa filling. You may notice that after filling and starting the spa, the pump appears to be non-functional. You can hear the pump running, but there's no water movement.</p> <ul style="list-style-type: none">• The pump will not work properly while air is trapped in it.• Continuing to operate the pump in this way will cause damage. <p>Whenever you fill your spa, fill it through the filter canister and make sure all jets are open.</p>
------------------	---

Power and system problems

System won't start up or breaker keeps shutting off	Power may be shut off. If this continues, contact your dealer or a qualified spa technician.
Communication problem between the control mainframe and the cycle pump.	Please check the connecting wire between the control main unit and the heat pump and replace it if necessary. Or please check if the heat pump is powered.
The control panel cannot communicate with the control mainframe	Check the connecting wire between the control panel and the control main unit. Replace if necessary.

Does not turn off	<p>Spa may be trying to heat up. Check if spa is in Ready or Rest mode. your spa water maintenance. In cold climates, if spa is not equipped with full foam or any kind of insulation, it will try to maintain the set temperature. Set the spa to low temperature range and set the temperature to 80°F (27°C). Maintaining your water quality helps the enjoyment of your spa and extends your spa's life by preventing damage from neglect and chemical abuse. Spa may be in filter cycle. If it is, this is normal and no adjustment is necessary.</p>
-------------------	--

Troubleshooting

Symptom	Possible Solutions
---------	--------------------

Chiller problems

water does not get cold	<ul style="list-style-type: none">Spa may be in high-temperature range. Set the spa to low-temperature range.Jet valves may be partially or fully closed. Open the jet valves.The filter may be dirty or may need to be replaced. Clean or replace the filter.Pump may have airlock. Remove airlock by priming the spa.The water level may be too low. Fill the spa with water level at 4 to 6 inches from the top.The suction fittings may be blocked. Remove any debris that may be blocking them.The temperature is not turned down low enough. Lower the temperature on topside control.The filter skimmer may be blocked. Remove the blockage.Cover the spa. The cover will keep cold in the spa and help to prevent any warmth from penetrating. Make sure the cover is on at all times when the spa is not in use.Gate valves may be closed. Open gate valves. Note: Never operate your spa with the gate valves closed!The cooling element may be old, deteriorated, coated with scale, or defective. Contact your dealer for more assistance.Spa may be running in heating mode. <p>The gate valves may be partially or completely closed. NEVER OPERATE YOUR SPA WITH THE GATE VALVES CLOSED!</p>
-------------------------	--

Other problems

The water is murky	<ul style="list-style-type: none">Ensure the filter is clean. This should be rinsed every month and changed every 3 months.Check there is a green light is on the ozonator Change the water if it has become too dirty.
Bad smell	<p>If the water looks clean and clear there should be no adverse smells. Run a clean cycle several times.</p> <p>If the water looks murky, drain and change it.</p>
The temperature is different to what my thermometer is showing	<p>The internal temperature probe is calibrated to within 0.3o +/-</p> <p>There could be an issue with the temperature sensor or PCB board.</p>